

# Installing the 1RU Chassis in a Rack

This Installation Guide describes how to install the Motion Graphics System 1RU chassis into a rack using the supplied rail kit.

## Package Contents

- 1RU chassis
- 2 x rails
- 2 x rail members
- 2 x chassis ears

## Required Tools

- #1 x 4 Phillips head screwdriver

## Installing the Chassis Ears

This procedure explains how to install the chassis ears on the sides of the 1RU Chassis.

### To install the chassis ears:

1. With the pin screws on the ears facing frontward, align the sides of chassis ears with the screw holes on the left and right sides of the chassis.
2. Insert and fasten the screws to the screw holes.

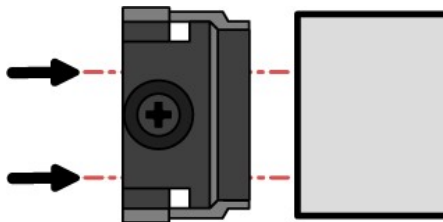

## Installing and Removing the Front Bezel

The following procedures explain how to install and remove the front bezel on the 1RU chassis.

### To install the front bezel:

1. Insert the right side of the bezel and snap it on to the front of the chassis.



2. Insert the key into the lock (1), rotate it 90° clockwise (2), and then remove the key (3).

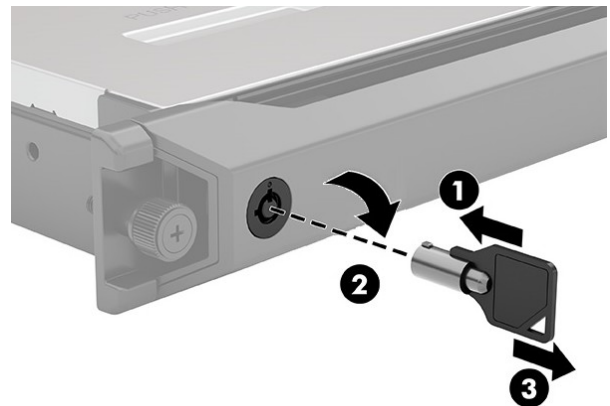

### To remove the front bezel:

1. Insert the key into the lock (1), rotate it 90° counterclockwise (2), and then remove the key (3).

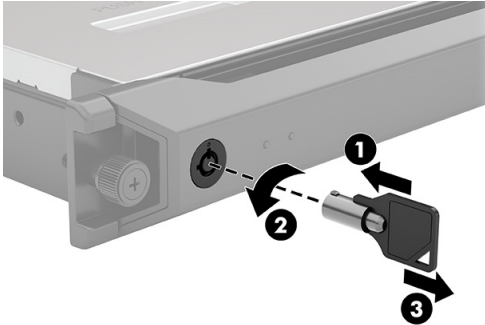

2. Rotate the left side of the bezel off the front of the chassis and then remove the bezel from the chassis.

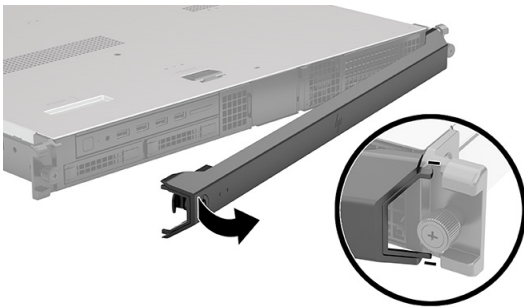

### Installing the Rail Member on the Chassis

This procedure explains how to install the rail members on the side of the Motion Graphics System 1RU chassis.

#### To install the rail members on the chassis:

1. Insert the tabs into the side of the chassis and then slide the glide forward (1).

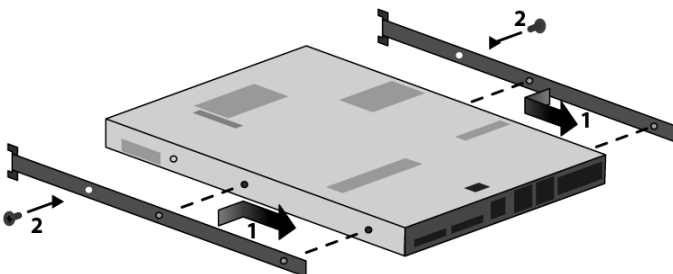

2. Next, attach the rear of the rail members with the screws (2).

### Installing the Rails in a Rack

#### To install the rails in a rack:

1. Align the square mounting pins on the rail to the mounting holes on the front of the rack.

★ For racks with round mounting holes, the square mounting pins on the rails retract, exposing smaller mounting pins that can be inserted into round mounting holes.

- a. Push the square mounting pin down, exposing the first round mounting pin.

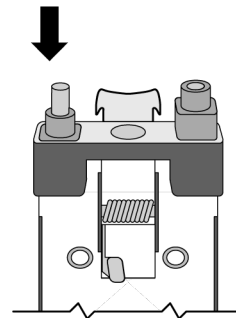

- b. Push the first round mounting pin down, exposing the second round mounting pin.

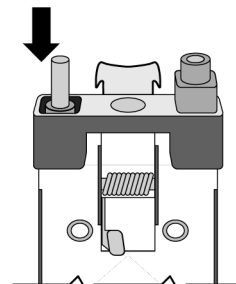

- c. Repeat steps a and b for the second set of pins.

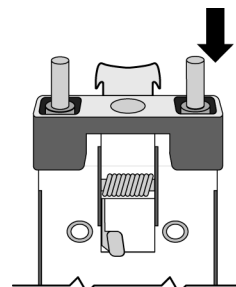

2. Push the rail forward until the mounting pins slide into the mounting holes on the rack.
3. A spring clip secures the end of the rail to the rack.
4. Repeat step 1 and 2 to attach the rear end of the rails, where a second set of spring clips secure the rail to the rack.

## Mounting the Chassis to the Rack

This procedure explains how to insert the Motion Graphics System 1RU chassis into a rack.



**Caution** — *It is recommended that at least two people mount the chassis to the rack.*

### To mount the chassis into the rack:

1. Insert the rear end of the chassis rail members into the front end of the rails.
2. Push the chassis towards the back of the rack until it reaches the end.
3. Tighten the screws on both sides of the front of the chassis.